

North Building (Directory)

SCHOOL OF ELECTRICAL, ELECTRONIC AND COMPUTER ENGINEERING. UWA

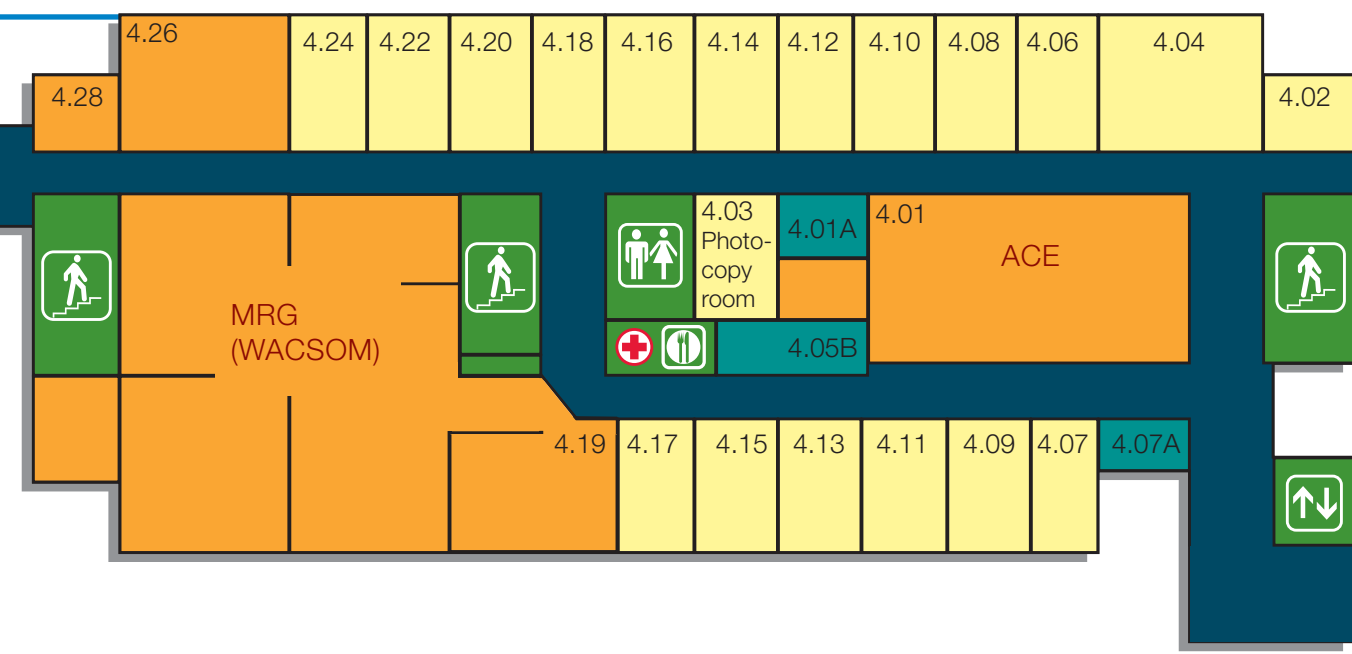

| | | |
|----------------------------------|-----------------------------|---|
| Staff | | |
| Linda Barbour..... 4.14 | Zig Budrikis..... 4.04 | Franz Schlagenhauer..... 4.04 |
| Administrative Assistant | Adjunct Professor | Associate Professor |
| Farid Boussaid..... 4.20 | Herbert Lu..... 4.09 | |
| Associate Professor | Associate Professor | |
| Thomas Braunl..... 4.15 | Mariusz Martyniuk..... 4.17 | Automation, Computing and Energy Research Group (ACE) |
| Associate Professor | Research Professor | Energy Systems Centre Lab..... 4.01 |
| Gary Bundell..... 4.12 | Ba Tuong Vo..... 4.11 | Microelectronics Research Group (MRG) |
| Professor | Postdoctoral Fellow | The Western Australian Centre for Semiconductor Optoelectronics and Microsystems Lab (WACSOM)..... 4.19 |
| Tony Cantoni..... 4.26 | Tam Nguyen..... 4.08 | Micro Metrology Lab..... 4.07 |
| Professor | Professor (Head of ACE) | |
| Tyrone Fernando..... 4.13 | Roberto Togneri..... 4.10 | |
| Associate Professor (Deputy HoS) | Associate Professor | |
| Cosimo Faiello..... 4.24 | Terry Woodings..... 4.18 | |
| Assistant Professor | Adjunct Associate Professor | |
| Tony Zaknich..... 4.16 | Dilusha Silva..... 4.22 | |
| Adjunct Associate Professor | Research Professor | |

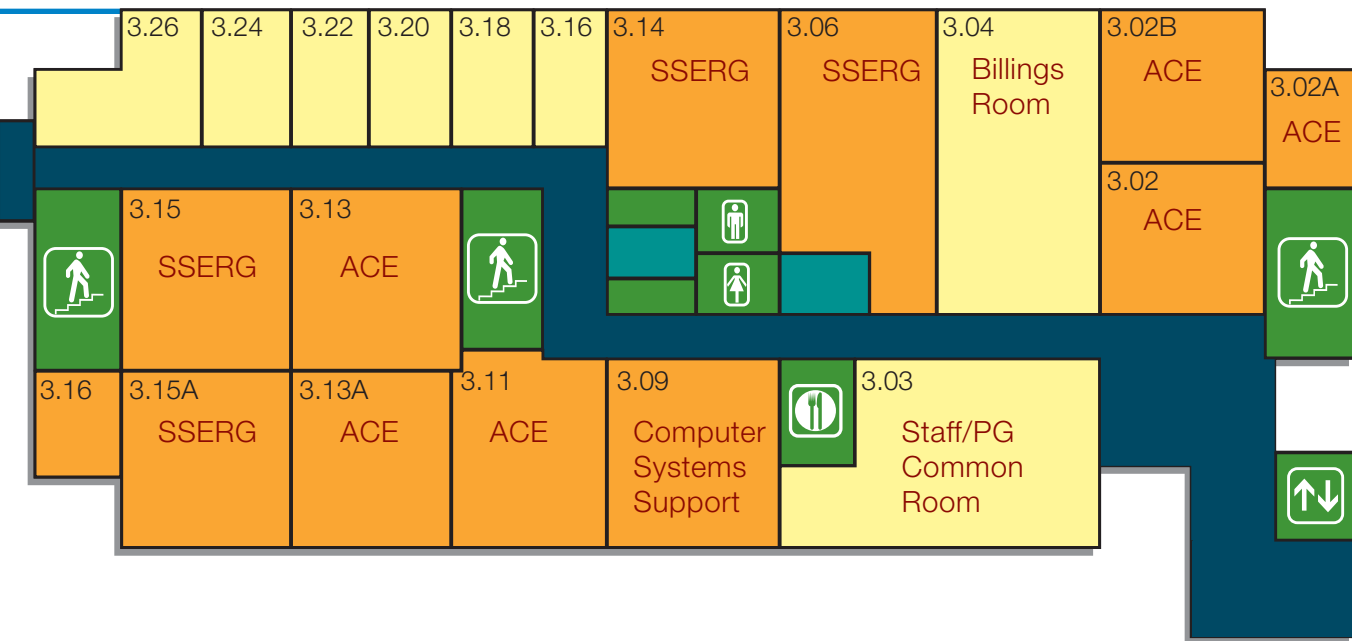

| | | |
|----------------------------|---|--|
| Staff | | |
| Tamara Fehlberg..... 3.22 | Automation, Computing and Energy Research Group (ACE) | Signal Processing for Wireless Communication Lab..... 3.15 |
| Associate Lecturer | Centre for Intelligent Information Processing Systems (CIIPS) Lab..... 3.11 | Billings Room..... 3.04 |
| Timothy Hillman..... 3.18 | Mobile Robot Lab..... 3.13 | Staff and Postgraduates Common Room..... 3.03 |
| Research Associate | High Energy Computer Systems Lab..... 3.02 | Computer Systems Support Staff |
| Dirk Lorensen..... 3.18 | | Tom Hallam..... Room 3.09 |
| Research Associate | Signals and Systems Engineering Research Group (SSEERG) | Information Systems Manager |
| David Huang..... 3.24 | Control Systems Lab..... 3.14 | Tim Rosenow..... Room 3.09 |
| Associate Professor | Signals and Information Processing Lab..... 3.06 | Computer Systems Officer |
| Victor Sreeram..... 3.16 | Systems and Biomedical Engineering Lab..... 3.15 | Jenny Vuong..... Room 3.09 |
| Professor (Head of SSEERG) | | Computer Systems Officer |

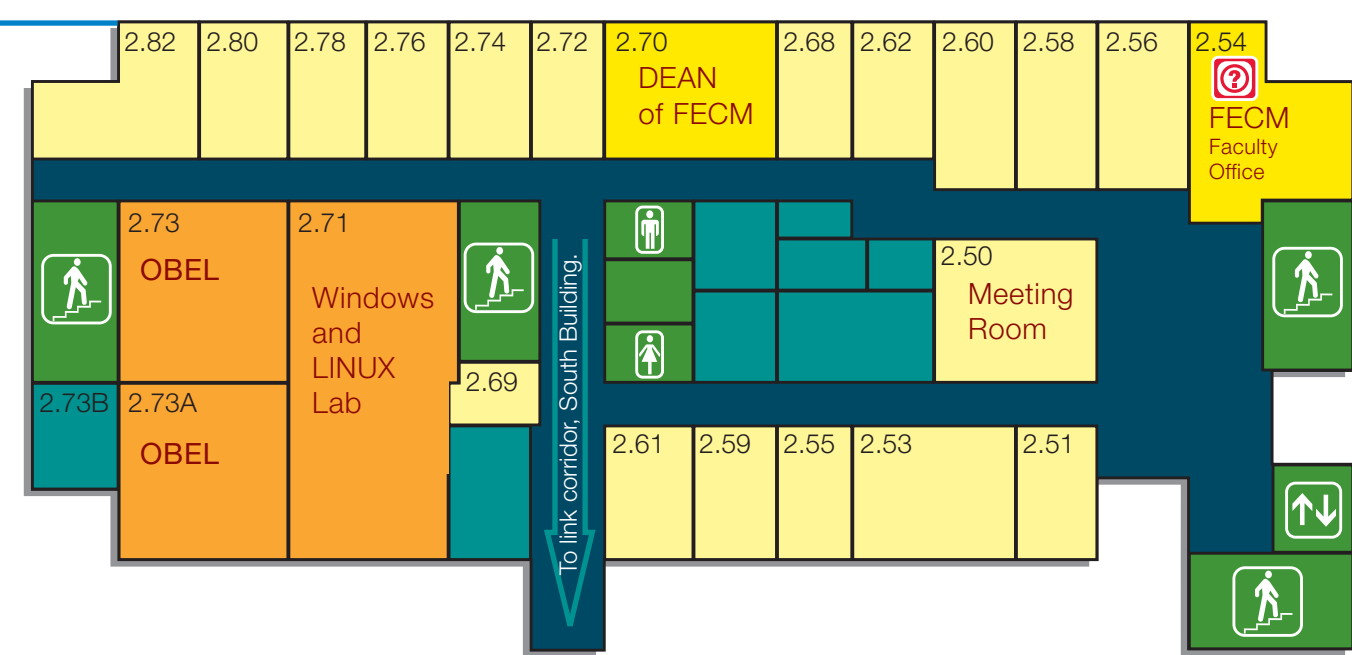

| | | |
|-----------------------------------|------------------------------|--|
| Staff | | |
| Sergey Alexandrov..... 2.51 | Rob McLaughlin..... 2.59 | Optical and Biomedical Engineering Research Group (OBEL) |
| Assistant Professor | Research Associate Professor | Postgraduate Lab..... 2.73 |
| Andrea Curatolo..... Lab 2.73 | Tracey O'Keefe..... 2.55 | Faculty of Engineering, Computing and Mathematics |
| Research Associate | Administrative Officer | Dean's Office..... 2.70 |
| Brendan Kennedy..... 2.78 | Brydan Quirk..... Lab 2.73 | Meeting Room..... 2.50 |
| Research Associate | Research Associate | Windows & LINUX Lab..... 2.71 |
| Rajesh Sreedharanpillai..... 2.78 | David Sampson..... 2.53 | |
| Research Associate | Professor (Head of OBEL) | |
| Rodney Kirk..... Lab 2.73 | Vincent Wallace..... 2.80 | |
| Research Assistant Professor | Research Associate Professor | |

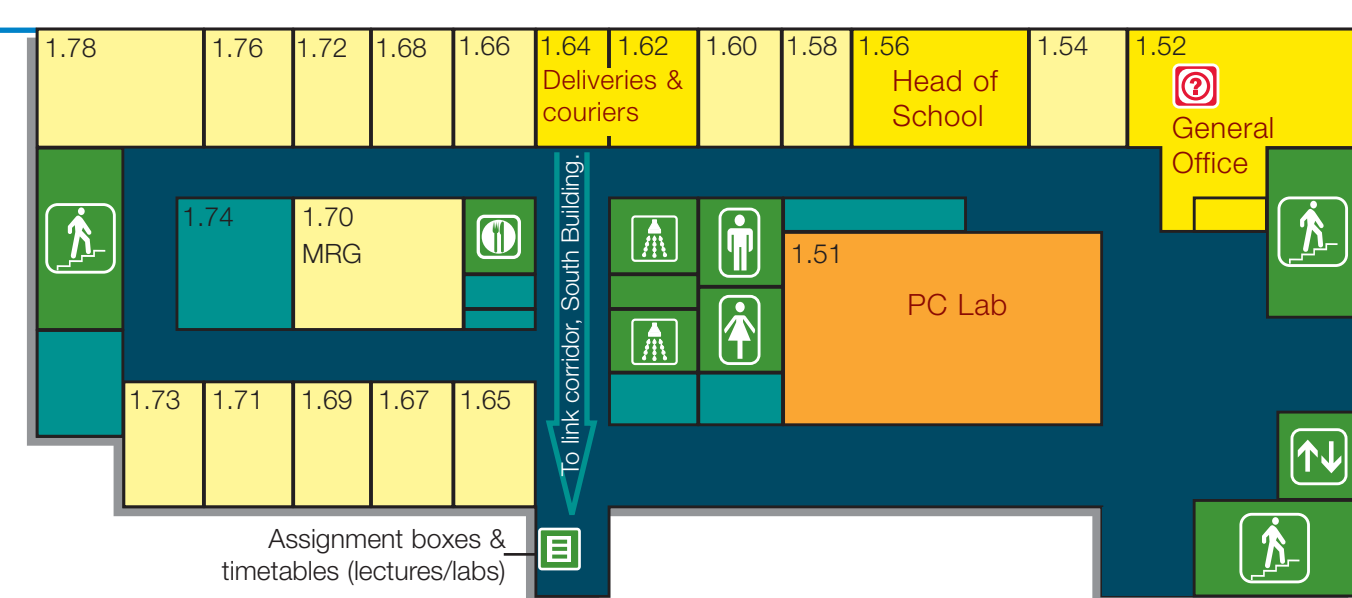

| | | |
|------------------------------|---|---|
| Staff | | |
| Brett Nener..... 1.56/1.72 | Georgia Wachmer..... 1.52 | Microelectronics Research Group (MRG) |
| Head of School/Professor | Administrative Officer | Laser Lab..... 1.70 |
| Lisa Brucciani..... 1.58 | Clive Dennis..... 1.62 | John Livingstone..... 1.69 |
| School Manager | Admin Officer (Assistant to School Manager) | Adjunct Senior Lecturer |
| Jarek Antoszewski..... 1.71 | Doris Dennis..... 1.60 | Rob Mattaboni..... 1.54 |
| Research Associate Professor | Accounts Officer | Admin Officer (Assistant to Head of School) |
| Michelle Bailey..... 1.52 | Laurie Faraone..... 1.78 | Gia Parish..... 1.76 |
| Administrative Officer | Professor (Head of MRG) | Associate Professor |
| Sabine Betts..... 1.73 | Head of School..... 1.56 | Charlie Musca..... 1.66 |
| Administrative Officer (MRG) | School Manager..... 1.58 | Adjunct Associate Professor |
| John Dell..... 1.68 | General Office..... 1.52 | Adrian Keating..... 1.66 |
| Professor | Deliveries & Couriers..... 1.62 | Adjunct Associate Professor |
| Luke Wilmot..... 1.52 | Photocopy and Blinding..... 1.65 | Jasmine Henry..... 1.67 |
| Administrative Assistant | PC Lab..... 1.51 | Associate Professor |

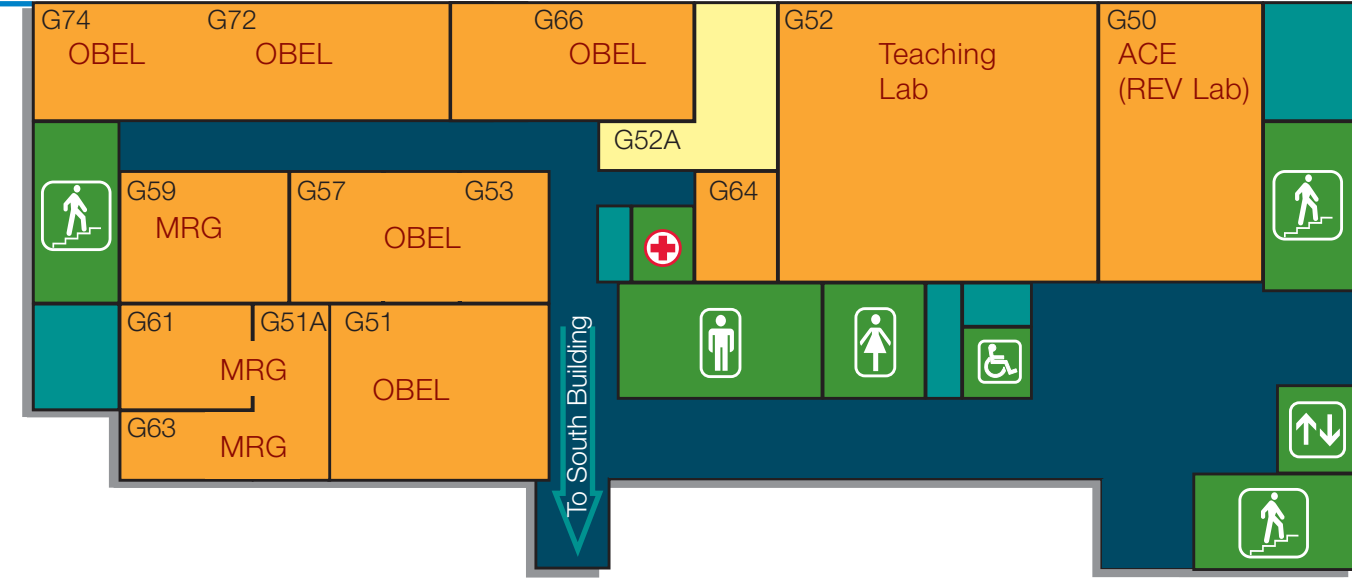

| | | |
|------------------------------|--|---|
| Staff | | |
| Stuart Mather..... Room G52A | Optical and Biomedical Engineering Research Group (OBEL) | Automation, Computing and Energy Research Group (ACE) |
| Lab Technician | Optics Lab..... G66, G72, G74 | (REV) Automotive Lab..... G50 |
| | Photonics Lab..... G51, G53, G57 | Teaching Lab..... G52 |
| | Microelectronics Research Group (MRG) | Biological Lab..... G64 |
| | Laser Lab..... G59, G51A, G61, G63 | |

| | | |
|---|---|--|
| <p>Research Groups</p> <p>ACE Automation, Computing and Energy Research Group Ph: 6488 3897</p> <p>OBEL Optical & Biomedical Engineering Research Group Ph: 6488 2317</p> <p>MRG Microelectronics Research Group Ph: 6488 3801</p> <p>SSEERG Signals and Systems Engineering Research Group Ph: 6488 3089</p> <p>TEN Telecommunications Engineering Networking Ph: 6488 7251</p> | <p>Main List</p> <p>Head of School 1st Floor 1.56 Ph: 6488 1622</p> <p>School Manager 1st Floor 1.58 Ph: 6488 3894</p> <p>General Enquiries 1st Floor 1.52 Ph: 6488 3898</p> <p>Faculty Office 2nd Floor 2.54 Ph: 6488 3000</p> <p>Computer Support 3rd Floor 3.09 Ph: 6488 1634</p> <p>Deliveries & Couriers 1st Floor 1.62 Ph: 6488 3103</p> | <p> Lift Stairs Kitchen First Aid Room Assignment Boxes & timetables Enquiries Showers Disabled Toilet Toilets </p> |
|---|---|--|

Staff Members (Directory)

SCHOOL OF ELECTRICAL, ELECTRONIC AND COMPUTER ENGINEERING. UWA

Staff Members A-Z

| | | |
|--------------------------|--|---------------------------|
| ALEXANDROV, Sergey | Research Assistant Professor | Rm 2.51 |
| ALLEN, Don | Senior Technician – Electronic Workshop | Rm G03 (South Building) |
| ANTOSZEWSKI, Jarek | Research Professor | Rm 1.71 |
| BAILEY, Michelle | Administrative Officer – General Office | Rm 1.52 |
| BARBOUR, Linda | Administrative Assistant – ACE Group | Rm 4.14 |
| BETTS, Sabine | Administrative Officer – MRG Group | Rm 1.73 |
| BOUSSAID, Farid | Associate Professor | Rm 4.20 |
| BRANT, Jonathan | Senior Technician – Electronic Workshop | Rm G03 (South Building) |
| BRAUNL, Thomas | Professor | Rm 4.15 |
| BRUCCIANI, Lisa | School Manager | Rm 1.58 |
| BUDRIKIS, Zig | Adjunct Professor | Rm 4.04 |
| BUNDELL, Gary | Professor | Rm 4.12 |
| CANTONI, Tony | Research Director | Rm 4.26 |
| CURATOLO, Andrea | Research Associate | Lab 2.73 |
| DELL, John | Professor | Rm 1.68 |
| DENNIS, Clive | Administrative Officer (Assistant to School Manager) | Rm 1.62 |
| DENNIS, Doris | Accounts Officer | Rm 1.60 |
| FAIELLO, Cosimo | Assistant Professor | Rm 4.24 |
| FARAONE, Laurie | Professor | Rm 1.78 |
| FEHLBERG, Tamara | Associate Lecturer | Rm 3.22 |
| FERNANDO, Tyrone | Deputy Head of School | Rm 4.13 |
| FOGDEN, Ken | Workshop Manager-General Workshop | Rm G20 (South Building) |
| HALLAM, Tom | Information Systems Manager | Rm 3.09 |
| HENRY, Jasmine | Associate Professor | Rm 1.67 |
| HUANG, David | Associate Professor | Rm 3.24 |
| HILLMAN, Timothy | Research Associate | Rm 3.18 |
| IU, Herbert | Associate Professor | Rm 4.09 |
| KENNEDY, Brendan | Research Associate | Rm 2.78 |
| KIRK, Rodney | Research Assistant Professor | Rm 2.73 |
| LIVINGSTONE, John | Adjunct Senior Lecturer | Rm 1.69 |
| LORENSER, Dirk | Research Assistant Professor | Rm 3.18 |
| MARTYNIUK, Mariusz | Research Professor | Rm 4.17 |
| MATHER, Stuart | Lab Technician | Rm G52a |
| MATTABONI, Rob | Administrative Officer (Assistant to Head of School) | Rm 1.54 |
| McLAUGHLIN, Rob | Research Associate Professor | Rm 2.59 |
| NENER, Brett | Head of School | Rm 1.56 |
| NGUYEN, Tam | Professor | Lab 4.01/Rm 4.08 |
| NGUYEN, Thuyen | Research Associate Professor | Lab 1.21 (South Building) |
| O'KEEFE, Tracey | Administrative Officer – OBEL Group | Rm 2.55 |
| PARISH, Gia | Associate Professor | Rm 1.76 |
| QUIRK, Bryden | Research Associate | Rm G51 |
| ROSENOW, Tim | Computer Systems Officer | Rm 3.09 |
| SAMPSON, David | Professor | Rm 2.53 |
| SCHLAGENHAUFER, Franz | Associate Professor | Rm 4.04 |
| SCHULER, Leo | Research Assistant Professor | Lab 1.21 (South Building) |
| SCHURMANN, John | Chief Technician – Electronic Workshop | Rm G03A (South Building) |
| SHARDA, Hema | Director – South Asian Relations | Rm 2.69 |
| SHEARN, Neil | Apprentice Technician – General Workshop | Rm G20 (South Building) |
| SILVA, Dilusha | Research Professor | Rm 4.22 |
| SREERAM, Victor | Professor | Rm 3.16 |
| SREEDHARANPILLAI, Rajesh | Research Associate | Rm 2.78 |
| TOGNERI, Roberto | Associate Professor | Rm 4.10 |
| UMANA-MEMBRENO, Gilberto | Senior Research Fellow | Lab 1.21 (South Building) |
| VO, Ba Tuong | Post Doctoral Fellow | Rm 4.11 |
| VOYT, George | Senior Technician – General Workshop | Rm G20C (South Building) |
| VUONG, Jenny | Computer Systems Officer | Rm 3.09 |
| WACHMER, Georgia | Administrative Officer | Rm 1.52 |
| WALLACE, Vincent | Research Associate Professor | Rm 2.80 |
| WILMOT, Luke | Administrative Assistant | Rm 1.52 |
| WOODINGS, Terry | Adjunct Associate Professor | Rm 4.18 |
| ZAKNICH, Tony | Adjunct Associate Professor | Rm 4.16 |
| ZVISON, Nir | Research Officer | Lab 1.21 (South Building) |

Main List

| | |
|--|--------------------------------------|
| HEAD OF SCHOOL | |
| Professor Brett Nener..... | Rm 1.56 |
| DEPUTY HEAD OF SCHOOL | |
| A/Prof Tyrone Fernando..... | Rm 4.13 |
| COURSE ADVISORS | |
| Undergraduate Course Advisor | |
| A/Prof Farid Boussaid..... | Rm 1.67 |
| Undergraduate Course Co-ordinator | |
| BE (EE)..... | A/Prof Farid Boussaid Rm 1.67 |
| BE (IT)..... | Prof Thomas Braunl Rm 4.15 |
| BE (PC)..... | A/Prof Tyrone Fernando Rm 4.13 |
| BE/BCom..... | Prof Thomas Braunl Rm 4.15 |
| BE/BSc..... | Prof Tam Nguyen Rm 4.08 |
| Postgraduate Course Co-ordinators | |
| MEICT..... | Prof Thomas Braunl Rm 4.15 |
| MEME..... | Prof Laurie Faraone Rm 1.78 |
| ME(PS)..... | Prof Tam Nguyen Rm 4.08 |

| | |
|--|---------|
| RESEARCH GROUPS | |
| Automation, Computing and Energy Research Group (ACE) | |
| Prof Tam Nguyen Head of ACE..... | Rm 4.08 |
| Ms Linda Barbour Administrative Secretary..... | Rm 4.14 |
| Signals and Systems Engineering Research Group (SSE) | |
| Prof Victor Sreeram Head of SSEERG..... | Rm 3.16 |
| Optical & Biomedical Engineering Research Group (OBEL) | |
| Prof David Sampson Head of OBEL..... | Rm 2.53 |
| Ms Tracey O'Keefe Administrative Officer..... | Rm 2.55 |
| Microelectronics Research Group (MRG) | |
| Prof Laurie Faraone Head of MRG..... | Rm 1.78 |
| Mrs Sabine Betts Administrative Officer..... | Rm 1.73 |
| Telecommunications Engineering Networking Research Group (TEN) | |
| Prof Tony Cantoni Head of TEN..... | Rm 4.26 |

| | |
|-----------------------------------|---------|
| FACULTY OFFICE – 2ND FLOOR | |
| Dean | |
| Professor David Smith..... | Rm 2.70 |
| Associate Dean (Students) | |
| Dr Jenny Hopwood..... | Rm 2.58 |
| Associate Dean (Postgraduate) | |
| Dr Lisa Beckley..... | Rm 2.60 |
| Associate Dean (Academic) | |
| Dr Angus Tavner..... | Rm 2.60 |
| Faculty General Manager | |
| Ms Paula Langley..... | Rm 2.62 |
| Manager Student Affairs | |
| Mr Rob Blandford..... | Rm 2.56 |
| Manager Special Projects | |
| Mr Stuart Broadfoot..... | Rm 2.82 |
| Marketing Manager | |
| Ms Danni Wick..... | Rm 2.61 |
| Ms Narelle Molloy..... | Rm 2.72 |

South Building (Directory)

SCHOOL OF ELECTRICAL, ELECTRONIC AND COMPUTER ENGINEERING. UWA

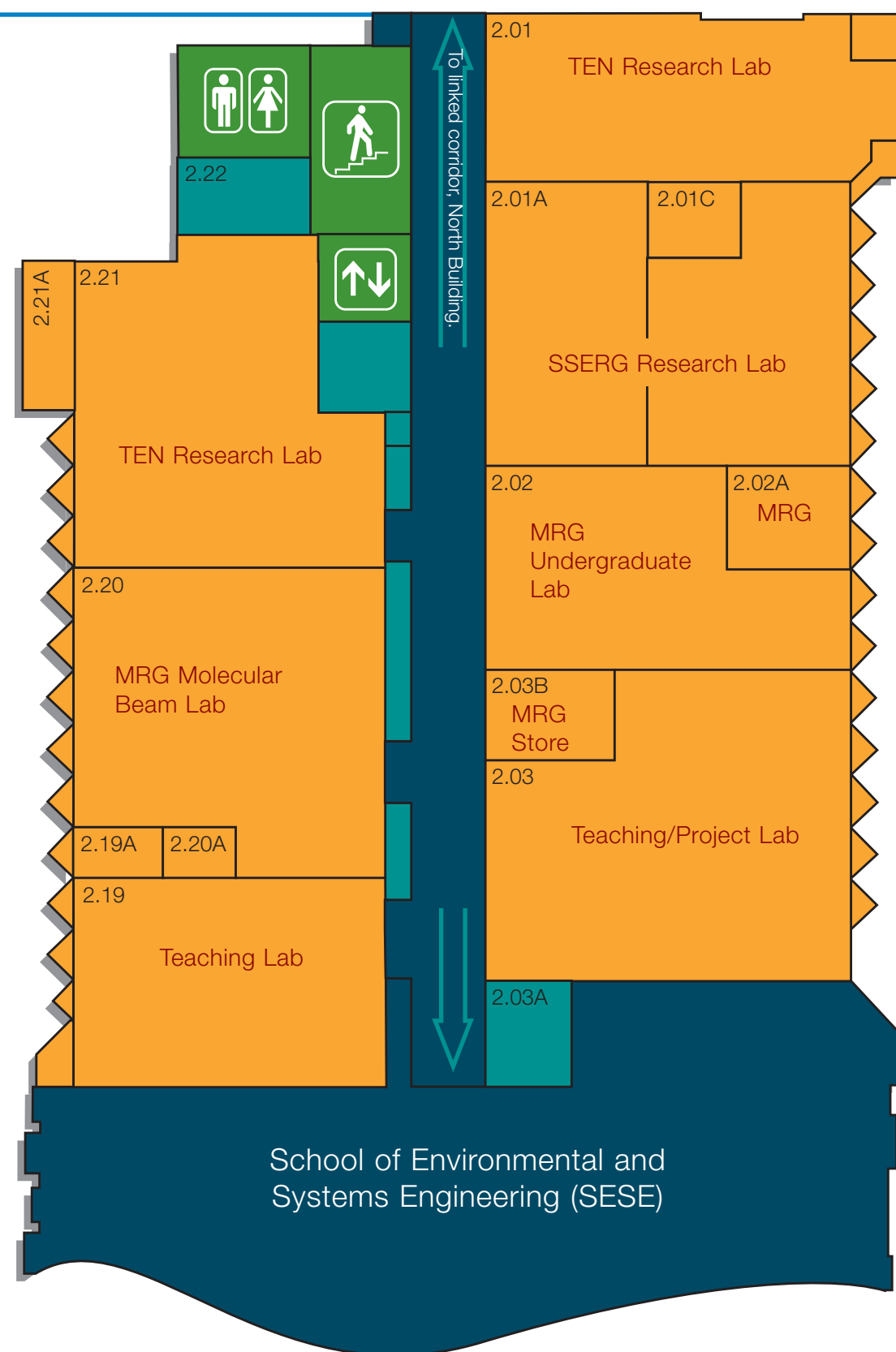

Teaching Laboratory

Teaching Lab Lab 2.19
Project Lab Lab 2.03

Microelectronics Research Group (MRG)

Undergraduates Lab Final Year Project Students Lab 2.02
MBE Lab Research Lab Lab 2.20

Signals and Systems Engineering Research Group (SSERG)

Research Lab Final Year Project Students Lab 2.01A

Telecommunications Engineering Networking Research Group (TEN)

Research Lab Rm 2.01
Research Lab Rm 2.21

Students Workshop access from 2nd floor

Students Workshop (Authorised Access Only) Rm 3.03

School of Environmental and Systems Engineering (SESE)

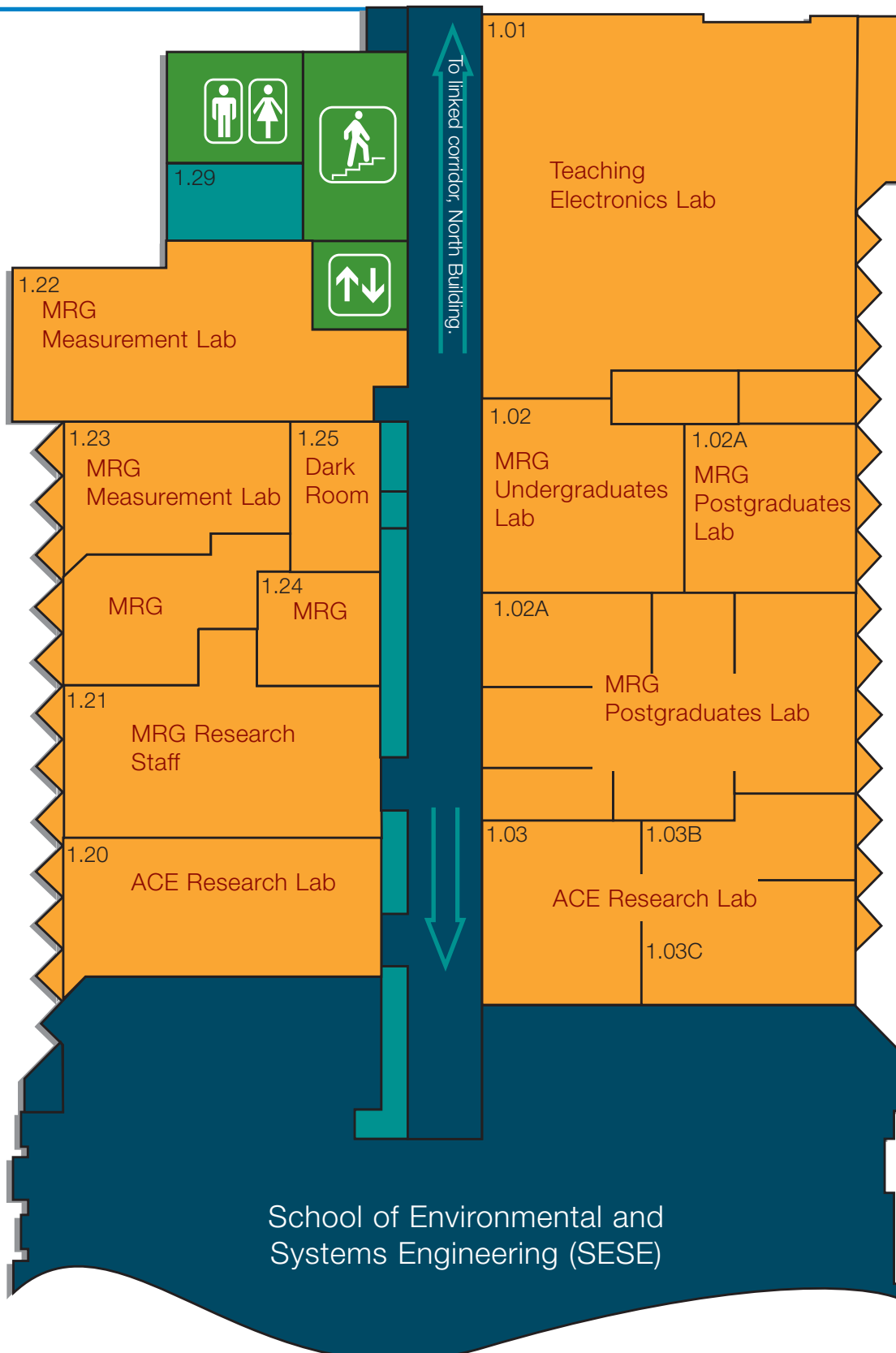

Teaching Laboratory

Teaching Lab Lab 1.01

Automation and Computing Energy Research Group (ACE)

Research Lab Lab 1.03
Research Lab Lab 1.20

Microelectronics Research Group (MRG)

Undergraduates Lab Final Year Project Students Lab 1.02
Postgraduates Lab Postgraduate Students Lab 1.02A
Researchers Office Research Staff Lab 1.21
Measurement Lab Final Year Project Students Lab 1.22

School of Environmental and Systems Engineering (SESE)

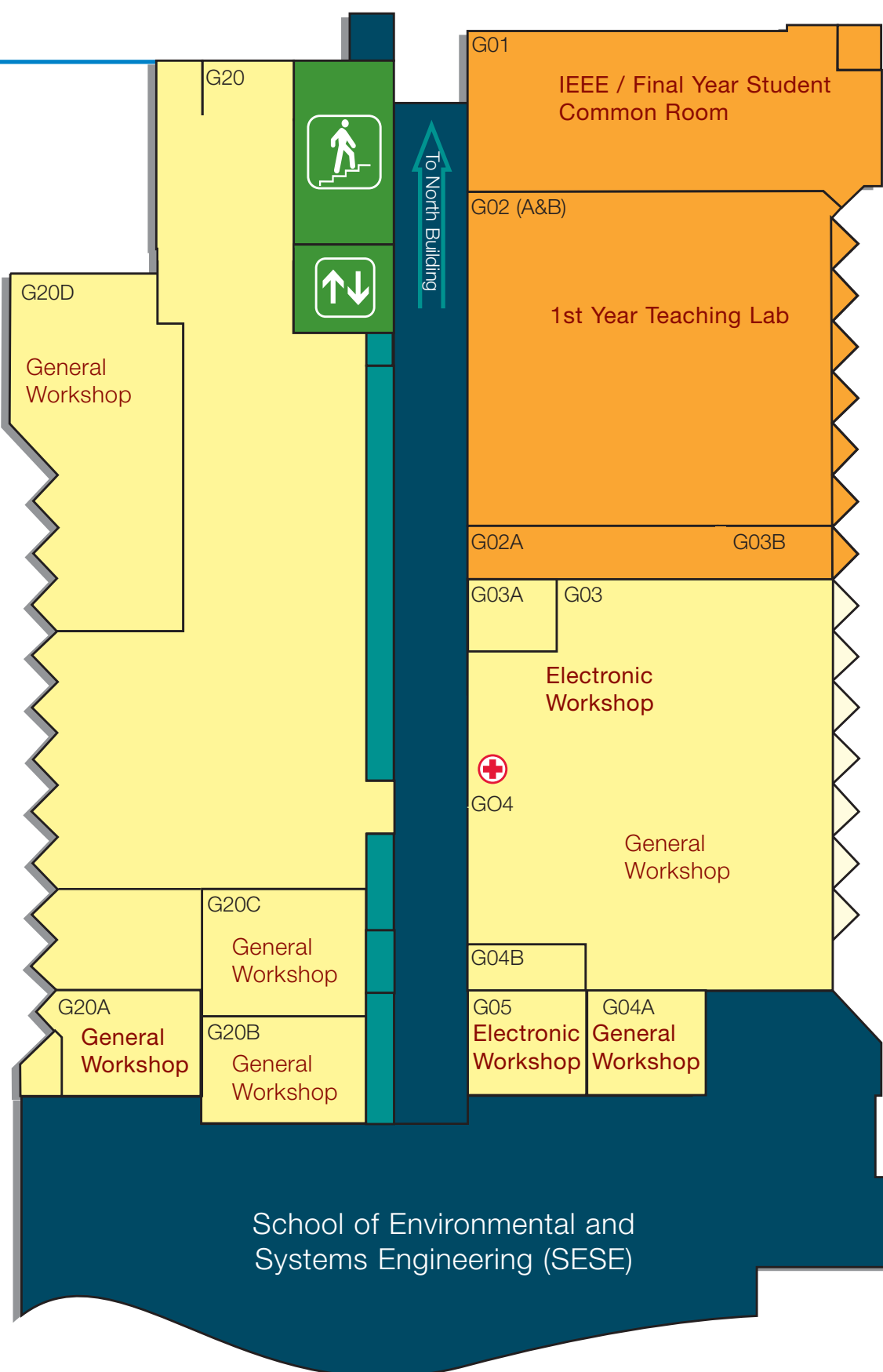

General Workshop

Neil Shearn Apprentice Room G20
Ken Fogden Workshop Manager Room G20
George Voyt Senior Technician Room G20A

Electronic Workshop

John Schurmann Chief Technician Room G03A
Jonathan Brant Room G03
Don Allen Room G03

Teaching Laboratories

Teaching Lab Lab G02

Student Common Room/IEEE Student Branch

Final Year Electrical, Electronic and Computer Engineering Students only Room G01

School of Environmental and Systems Engineering (SESE)

Staff Members (Directory)

SCHOOL OF ELECTRICAL, ELECTRONIC AND COMPUTER ENGINEERING. UWA

Staff Members A-Z

| | | |
|--------------------------|--|---------------------------|
| ALEXANDROV, Sergey | Research Assistant Professor | Rm 2.51 |
| ALLEN, Don | Senior Technician – Electronic Workshop | Rm G03 (South Building) |
| ANTOSZEWSKI, Jarek | Research Professor | Rm 1.71 |
| BAILEY, Michelle | Administrative Officer – General Office | Rm 1.52 |
| BARBOUR, Linda | Administrative Assistant – ACE Group | Rm 4.14 |
| BETTS, Sabine | Administrative Officer – MRG Group | Rm 1.73 |
| BOUSSAID, Farid | Associate Professor | Rm 4.20 |
| BRANT, Jonathan | Senior Technician – Electronic Workshop | Rm G03 (South Building) |
| BRAUNL, Thomas | Professor | Rm 4.15 |
| BRUCCIANI, Lisa | School Manager | Rm 1.58 |
| BUDRIKIS, Zig | Adjunct Professor | Rm 4.04 |
| BUNDELL, Gary | Professor | Rm 4.12 |
| CANTONI, Tony | Research Director | Rm 4.26 |
| CURATOLO, Andrea | Research Associate | Lab 2.73 |
| DELL, John | Professor | Rm 1.68 |
| DENNIS, Clive | Administrative Officer (Assistant to School Manager) | Rm 1.62 |
| DENNIS, Doris | Accounts Officer | Rm 1.60 |
| FAIELLO, Cosimo | Assistant Professor | Rm 4.24 |
| FARAONE, Laurie | Professor | Rm 1.78 |
| FEHLBERG, Tamara | Associate Lecturer | Rm 3.22 |
| FERNANDO, Tyrone | Deputy Head of School | Rm 4.13 |
| FOGDEN, Ken | Workshop Manager-General Workshop | Rm G20 (South Building) |
| HALLAM, Tom | Information Systems Manager | Rm 3.09 |
| HENRY, Jasmine | Associate Professor | Rm 1.67 |
| HUANG, David | Associate Professor | Rm 3.24 |
| HILLMAN, Timothy | Research Associate | Rm 3.18 |
| IU, Herbert | Associate Professor | Rm 4.09 |
| KENNEDY, Brendan | Research Associate | Rm 2.78 |
| KIRK, Rodney | Research Assistant Professor | Rm 2.73 |
| LIVINGSTONE, John | Adjunct Senior Lecturer | Rm 1.69 |
| LORENSER, Dirk | Research Assistant Professor | Rm 3.18 |
| MARTYNIUK, Mariusz | Research Professor | Rm 4.17 |
| MATHER, Stuart | Lab Technician | Rm G52a |
| MATTABONI, Rob | Administrative Officer (Assistant to Head of School) | Rm 1.54 |
| McLAUGHLIN, Rob | Research Associate Professor | Rm 2.59 |
| NENER, Brett | Head of School | Rm 1.56 |
| NGUYEN, Tam | Professor | Lab 4.01/Rm 4.08 |
| NGUYEN, Thuyen | Research Associate Professor | Lab 1.21 (South Building) |
| O'KEEFE, Tracey | Administrative Officer – OBEL Group | Rm 2.55 |
| PARISH, Gia | Associate Professor | Rm 1.76 |
| QUIRK, Bryden | Research Associate | Rm G51 |
| ROSENOW, Tim | Computer Systems Officer | Rm 3.09 |
| SAMPSON, David | Professor | Rm 2.53 |
| SCHLAGENHAUFER, Franz | Associate Professor | Rm 4.04 |
| SCHULER, Leo | Research Assistant Professor | Lab 1.21 (South Building) |
| SCHURMANN, John | Chief Technician – Electronic Workshop | Rm G03A (South Building) |
| SHARDA, Hema | Director – South Asian Relations | Rm 2.69 |
| SHEARN, Neil | Apprentice Technician – General Workshop | Rm G20 (South Building) |
| SILVA, Dilusha | Research Professor | Rm 4.22 |
| SREERAM, Victor | Professor | Rm 3.16 |
| SREEDHARANPILLAI, Rajesh | Research Associate | Rm 2.78 |
| TOGNERI, Roberto | Associate Professor | Rm 4.10 |
| UMANA-MEMBRENO, Gilberto | Senior Research Fellow | Lab 1.21 (South Building) |
| VO, Ba Tuong | Post Doctoral Fellow | Rm 4.11 |
| VOYT, George | Senior Technician – General Workshop | Rm G20C (South Building) |
| VUONG, Jenny | Computer Systems Officer | Rm 3.09 |
| WACHMER, Georgia | Administrative Officer | Rm 1.52 |
| WALLACE, Vincent | Research Associate Professor | Rm 2.80 |
| WILMOT, Luke | Administrative Assistant | Rm 1.52 |
| WOODINGS, Terry | Adjunct Associate Professor | Rm 4.18 |
| ZAKNICH, Tony | Adjunct Associate Professor | Rm 4.16 |
| ZVISON, Nir | Research Officer | Lab 1.21 (South Building) |

Main List

HEAD OF SCHOOL

Professor Brett Nener Rm 1.56

DEPUTY HEAD OF SCHOOL

A/Prof Tyrone Fernando Rm 4.13

COURSE ADVISORS

Undergraduate Course Advisor

A/Prof Farid Boussaid Rm 1.67

Undergraduate Course Co-ordinator

BE (EE) A/Prof Farid Boussaid Rm 1.67
BE (IT) Prof Thomas Braunl Rm 4.15
BE (PC) A/Prof Tyrone Fernando Rm 4.13
BE/BCom Prof Thomas Braunl Rm 4.15
BE/BSc Prof Tam Nguyen Rm 4.08

Postgraduate Course Co-ordinators

MEICT Prof Thomas Braunl Rm 4.15
MEME Prof Laurie Faraone Rm 1.78
ME(PS) Prof Tam Nguyen Rm 4.08

RESEARCH GROUPS

Automation, Computing and Energy Research Group (ACE)

Prof Tam Nguyen Head of ACE Rm 4.08
Ms Linda Barbour Administrative Secretary Rm 4.14

Signals and Systems Engineering Research Group (SSE)

Prof Victor Sreeram Head of SSERG Rm 3.16

Optical & Biomedical Engineering Research Group (OBEL)

Prof David Sampson Head of OBEL Rm 2.53
Ms Tracey O'Keefe Administrative Officer Rm 2.55

Microelectronics Research Group (MRG)

Prof Laurie Faraone Head of MRG Rm 1.78
Mrs Sabine Betts Administrative Officer Rm 1.73

Telecommunications Engineering Networking Research Group (TEN)

Prof Tony Cantoni Head of TEN Rm 4.26

FACULTY OFFICE – 2ND FLOOR

Dean

Professor David Smith Rm 2.70

Associate Dean (Students)

Dr Jenny Hopwood Rm 2.58

Associate Dean (Postgraduate)

Dr Lisa Beckley Rm 2.60

Associate Dean (Academic)

Dr Angus Tavner Rm 2.60

Faculty General Manager

Ms Paula Langley Rm 2.62

Manager Student Affairs

Mr Rob Blandford Rm 2.56

Manager Special Projects

Mr Stuart Broadfoot Rm 2.82

Marketing Manager

Ms Danni Wick Rm 2.61
Ms Narelle Molloy Rm 2.72

Research Groups

ACE Automation, Computing and Energy Research Group Ph: 6488 3897
OBEL Optical & Biomedical Engineering Research Group Ph: 6488 2317
MRG Microelectronics Research Group Ph: 6488 3801
SSERG Signals and Systems Engineering Research Group Ph: 6488 3089
TEN Telecommunications Engineering Networking Ph: 6488 7251

Main List

Head of School 1st Floor 1.56 Ph: 6488 1622
School Manager 1st Floor 1.58 Ph: 6488 3894
General Enquiries 1st Floor 1.52 Ph: 6488 3898
Faculty Office 2nd Floor 2.54 Ph: 6488 3000
Computer Support 3rd Floor 3.09 Ph: 6488 1634
Deliveries & Couriers 1st Floor 1.62 Ph: 6488 3103

Lift
 Stairs
 Kitchen
 First Aid Room
 Assignment Boxes & timetables
 Enquiries
 Showers
 Disabled Toilet
 Toilets